

Molding Power Inductors -MCH Series

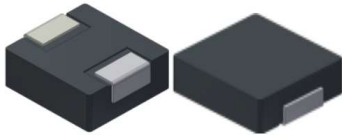

欣腾辉电子
XINTENGHUI ELECTRONICS

MCH Series



Description:

- RoHS, Halogen Free and REACH Compliance
- High current carrying capacity, Low core losses
- Carbon-based magnetic core material
- Frequency range up to 5MHz.
- Magnetically shielded, low EMI

Applications:

- Switches and servers
- Notebook regulators
- Battery power systems
- DC/DC converters

Product Identification

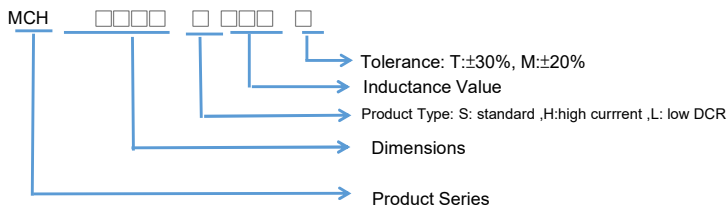

Dimensions-mm

Shape and Dimensions

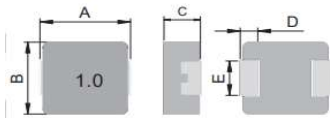

Recommended Pad Layout

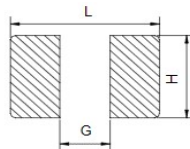

Dimensions-mm

TYPE	A	B	C	D	E
1265	13.5±0.5	12.5±0.3	6.2±0.3	2.3±0.3	4.7±0.3

Dimensions-mm

TYPE	L	G	H
1265	14.2	8.0	5.0

Molding Power Inductors -MCH Series

Electrical Characteristics

Part No.	Inductance (μ H)	Tolerance (\pm %)	Test Freq.	RDC(m Ω) Typ.	RDC(m Ω) Max.	Isat(A) Typ.	Isat(A) Max.	Irms(A) Typ.	Irms(A) Max.
MCH1265SR22M	0.22	30	100KHZ,1V	0.47	0.60	112.0	93.0	53.0	44.0
MCH1265SR33M	0.33	20	100KHZ,1V	0.65	0.80	68.0	56.4	46.0	38.2
MCH1265SR36M	0.36	20	100KHZ,1V	0.70	0.90	66.0	54.8	45.0	37.4
MCH1265SR47M	0.47	20	100KHZ,1V	0.90	1.20	63.0	52.3	41.0	34.0
MCH1265SR56M	0.56	20	100KHZ,1V	1.05	1.20	58.0	48.1	37.0	30.7
MCH1265SR68M	0.68	20	100KHZ,1V	1.25	1.50	55.0	45.7	35.0	29.1
MCH1265SR82M	0.82	20	100KHZ,1V	1.50	1.90	50.0	41.5	33.0	27.4
MCH1265S1R0M	1.00	20	100KHZ,1V	1.70	2.30	48.0	39.8	30.0	24.9
MCH1265S1R5M	1.50	20	100KHZ,1V	2.50	3.00	45.0	37.4	27.0	22.4
MCH1265S1R8M	1.80	20	100KHZ,1V	3.60	4.00	40.0	33.2	24.0	19.9
MCH1265S2R2M	2.20	20	100KHZ,1V	3.80	4.20	37.0	30.7	22.0	18.3
MCH1265S2R7M	2.70	20	100KHZ,1V	4.30	5.50	32.0	26.6	20.0	16.6
MCH1265S3R3M	3.30	20	100KHZ,1V	5.70	6.80	30.0	24.9	18.0	14.9
MCH1265S4R7M	4.70	20	100KHZ,1V	7.00	8.40	28.0	23.2	13.5	11.2
MCH1265S5R6M	5.60	20	100KHZ,1V	8.50	10.00	23.0	19.1	12.5	10.4
MCH1265S6R8M	6.80	20	100KHZ,1V	9.50	11.50	18.0	14.9	11.5	9.5
MCH1265S7R0M	7.00	20	100KHZ,1V	10.00	12.30	17.7	14.7	11.2	9.3
MCH1265S8R2M	8.20	20	100KHZ,1V	12.00	15.50	16.0	13.3	10.5	8.7
MCH1265S100M	10.00	20	100KHZ,1V	13.20	16.50	15.5	12.9	10.0	8.3
MCH1265S120M	12.00	20	100KHZ,1V	16.00	20.00	14.0	11.6	9.5	7.9
MCH1265S130M	13.00	20	100KHZ,1V	21.00	24.00	13.0	10.8	9.0	7.5
MCH1265S150M	15.00	20	100KHZ,1V	23.20	28.00	13.0	10.8	9.0	7.5
MCH1265S220M	22.00	20	100KHZ,1V	32.50	37.00	12.0	10.0	9.0	7.5
MCH1265S250M	25.00	20	100KHZ,1V	40.00	47.00	11.5	9.5	8.5	7.1
MCH1265S330M	33.00	20	100KHZ,1V	48.00	58.00	11.0	9.1	8.0	6.6
MCH1265S470M	47.00	20	100KHZ,1V	76.00	90.00	9.5	7.9	6.5	5.4
MCH1265S680M	68.00	20	100KHZ,1V	110.00	130.00	7.8	6.5	4.8	4.0
MCH1265S101M	100.00	20	100KHZ,1V	145.00	165.00	5.5	4.6	4.2	3.5

Notes:

- All test data is referenced to 25°C ambient.
- Operating temperature range -55°C to +125°C (Including self - temperature rise)
- Irms(A):DC current(A) that will cause an approximate Δ T of 40°C (reference ambient temperature is 25°C)
- Saturation Current (Isat) will cause L0 to drop approximately 30%(Isat).
- Measure Equipment :
L : Wayne kerr 3260B/G LCR Meter (or equivalent), 100KHz 1.0V
RDC : CHEN HWA502BC/HP4338B (or equivalent)
Isat : Wayne kerr 3265B Bias Current Source (or equivalent)
Irms : Wayne kerr 3265B Bias Current Source (or equivalent)
- Test Condition:
Temperature:26 \pm 3°C
Humidity:<70% RH
Frequency:100KHz 1.0V
- Absolute maximum voltage 80VDC

Molding Power Inductors -MCH Series

Curve:

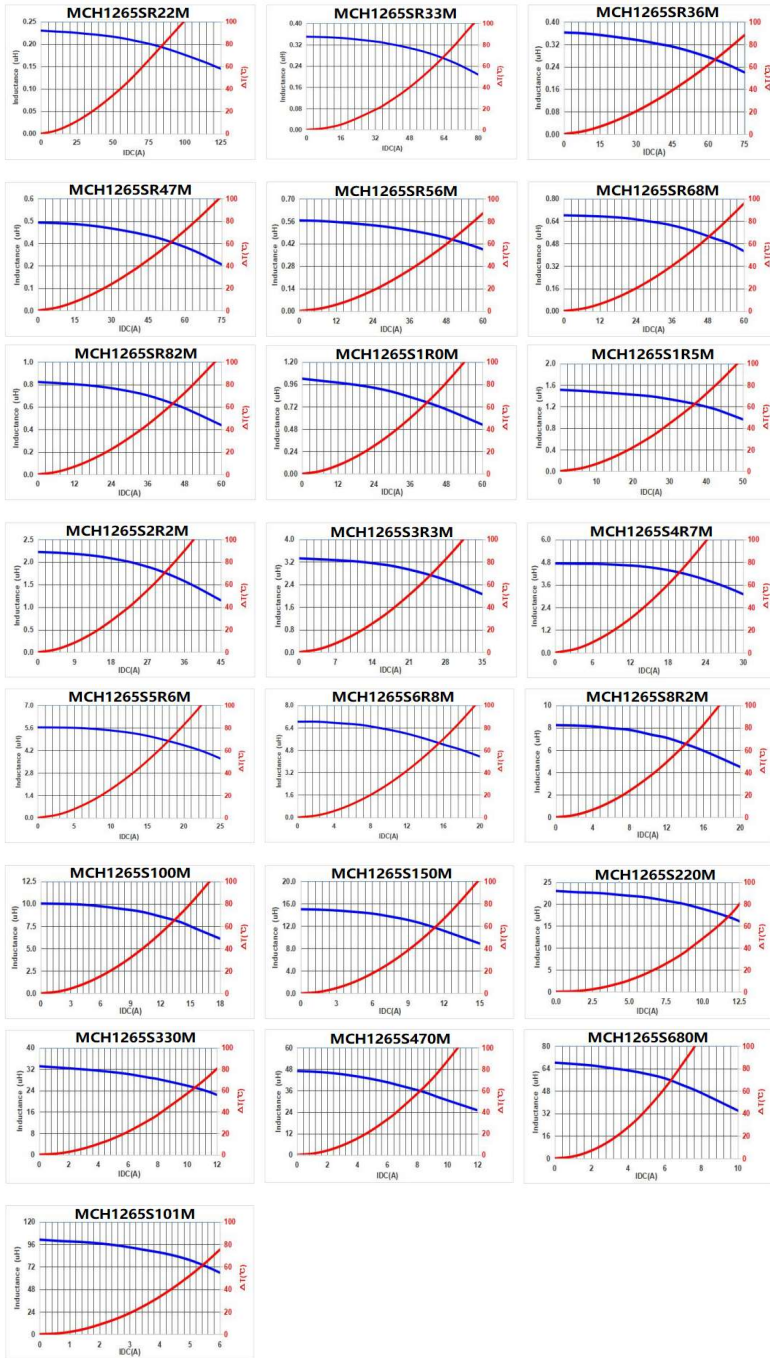

Molding Power Inductors -MCH Series

Packaging:

Packaging -Cover Tape

The force for tearing off cover tape is 10 to 130 grams in the arrow direction.

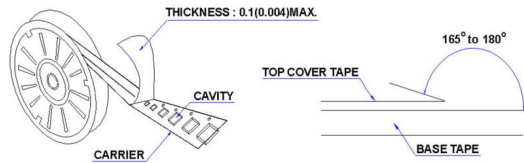

Packaging quantity

Series	PCS/REEL
MCH1265	500

Reel Dimensions

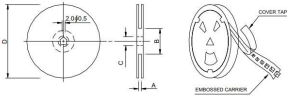

Reel Dimensions:mm

Series	Type	A	B	C	D
MCH1265	13"x24mm	24.4+2/-0	100±2	13+0.5/0.2	330

Tape Dimensions in mm

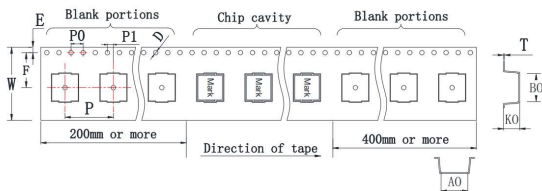

Series	B0	A0	K0	P	W	D	E	F	P1	P0	T
MCH1265	14.8±0.1	13.0±0.1	7.0±0.1	16.0±0.1	24±0.3	1.5±0.1	1.75±0.1	11.5±0.1	2.0±0.1	4.0±0.1	0.50±0.05