

产 品 承 认 书
SPECIFICATION FOR APPROVAL

客户名称 <i>CUSTOMER NAME.</i>	
产品类型 <i>PRODUCT TYPE</i>	贴片电感
客户料号 <i>CUSTOMER P/N</i>	MTH0650S2R2M
料号 <i>OURS P/N</i>	MTH0650S2R2M
文件编号 <i>FILE NO.</i>	

批准 <i>APPROVED</i>	确认 <i>CHECKED</i>	作成 <i>DESIGN</i>
Ruby	Ruby	John

<i>客户承认/CUSTOMER ACCEPTED</i>		
承认 <i>APPROVED</i>	确认 <i>CHECKED</i>	承办 <i>DESIGN</i>
<i>批注/REMARK</i>		

苏州欣腾辉电子有限公司
SUZHU XINTENGHUI ELECTRONIC CO., LTD.

承认书/SPECIFICATION FOR APPROVAL

客户名称 CUSTOMER	0	客户品名 CUSTOMER P/N	MTH0650S2R2M	版别 REV.	A
产品类型 PRODUCT TYPE	贴片电感	品名 OURS P/N	MTH0650S2R2M	文件编号 FILE NO.	

一.外观图/DIMENSION (单位/UNIT: mm)

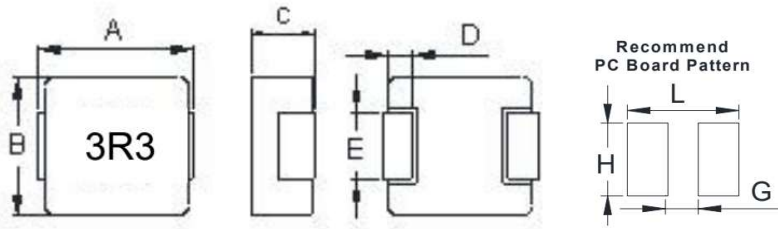

A	7.3±0.3
B	6.6±0.3
C	4.8±0.2
D	1.6±0.3
E	3.0±0.2
L	8.0Ref
G	3.7Ref
H	3.4Ref

二. 电路图/CIRCUIT DIAGRAM

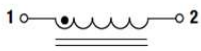

三. 电气特性/ELECTRICAL CHARACTERISTIC

Part Number	Inductance (u H) 100KHZ/1.0V	Isat (A)	Irms (A)	DCR (mΩ)Typ.	DCR (mΩ)Max.
MTH0605S2R2M	2.2±20%	10	14	10.0	11.5

1. All test data is referenced to 25°C ambient.
2. Operating temperature range -55°C to +125°C (Including self - temperature rise)
3. Irms(A): DC current(A) that will cause an approximate ΔT of 40°C (reference ambient temperature is 25°C)
4. Isat(A): DC current(A) that will cause L0 to drop approximately 30%.
5. Measure Equipment :
 L : Wayne kerr 3260B/G LCR Meter (or equivalent), 100KHz 1.0V
 RDC : CHEN HWA502BC/HP4338B (or equivalent)
 Isat : Wayne kerr 3265B Bias Current Source (or equivalent)
 Irms : Wayne kerr 3265B Bias Current Source (or equivalent)
6. Test Condition:
 Temperature: 26±3°C
 Humidity: <70% RH
 Frequency: 100KHz 1.0V
7. Absolute maximum voltage 50VDC

拟制	John	审核	Ruby	批准	Ruby
----	------	----	------	----	------

承认书/SPECIFICATION FOR APPROVAL

客户名称 CUSTOMER		客户品名 CUSTOMER P/N	MTH0650S2R2M	版别 REV.	A
产品类型 PRODUCT TYPE	贴片电感	品名 OURS P/N	MTH0650S2R2M	文件编号 FILE NO.	

四. 材料清单/MATERIAL LIST

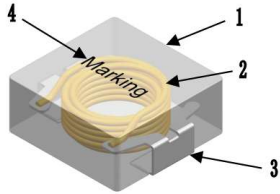

NO	Items	Materials
1	Core	Metal Powder.
2	Wire	Polyamide-imide Wire or equivalent.
3	Clip	100% Pb free solder. (Ni+Sn---Plating)
4	Ink	Halogen-free ketone.

五. 编带规格/TAPING SPECIFICATIONS

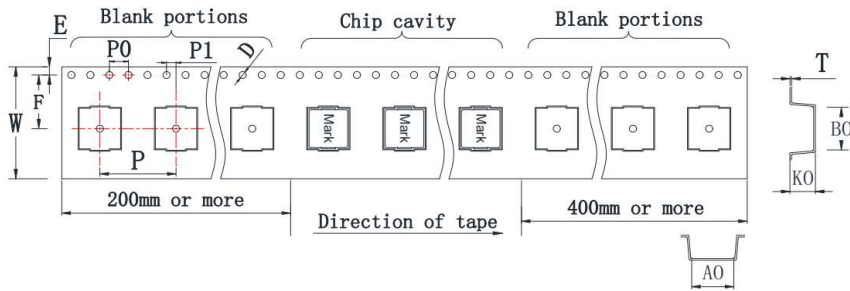

Series	Bo	Ao	Ko	P	W	D	E	F	P1	P0	T	Reel (PCS)
0605	7.7±0.1	7.1±0.1	5.3±0.1	12.0±0.1	16.0±0.3	1.5±0.1	1.75±0.1	7.5±0.1	2.0±0.1	4.0±0.1	0.35±0.05	800

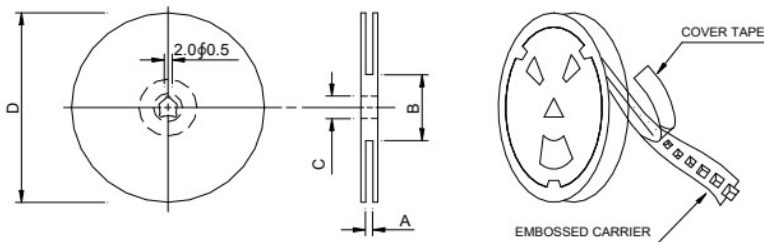

Series	Type	A	B	C	D
0605	13"x16mm	16.4+2/-0	100±2	13+0.5/-0.2	330

拟制	John	审核	Ruby	批准	Ruby
----	------	----	------	----	------

承认书/SPECIFICATION FOR APPROVAL

客户名称 CUSTOMER	0	客户品名 CUSTOMER P/N	MTH0650S2R2M	版别 REV.	A
产品类型 PRODUCT TYPE	贴片电感	品名 OURS P/N	MTH0650S2R2M	文件编号 FILE NO.	

七. 可靠性测试/RELIABILITY TESTING

Operating Temperature	- 55 to +125 °C (Contain Heating coil)
Appearance Inspection	No external defects by visual inspection
Terminal Strength	After soldering , between copper plaet and terminals of coils , push in two directions of X , Y with standing 10N(1.02kg) for10+/-2 sec. Terminal should not peel off. (Refer to figure at right)
Heat endurance of reflow soldering	Refer to figure
Insulating resistance	Over 100 MΩ at 100V D.C . between wire and core
Dielectric Strength	Apply at 0.5KV 3mA for 1 minute between wire and core
Temperature characteristics	Inductance coefficient (0~2,000) × 10 / °C (- 40~ + 125 °C)
Humidity characteristics	Inductance deviation within ± 10% , after 96 hours in 90~95% relative humidity at 40 ± 2 °C and 1 hours drying under normal condition

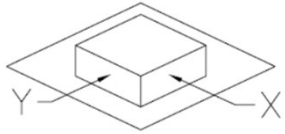

A test is made under the above mentioned condition , and it is kept for 2 hours in the normal

IR Reflow profile

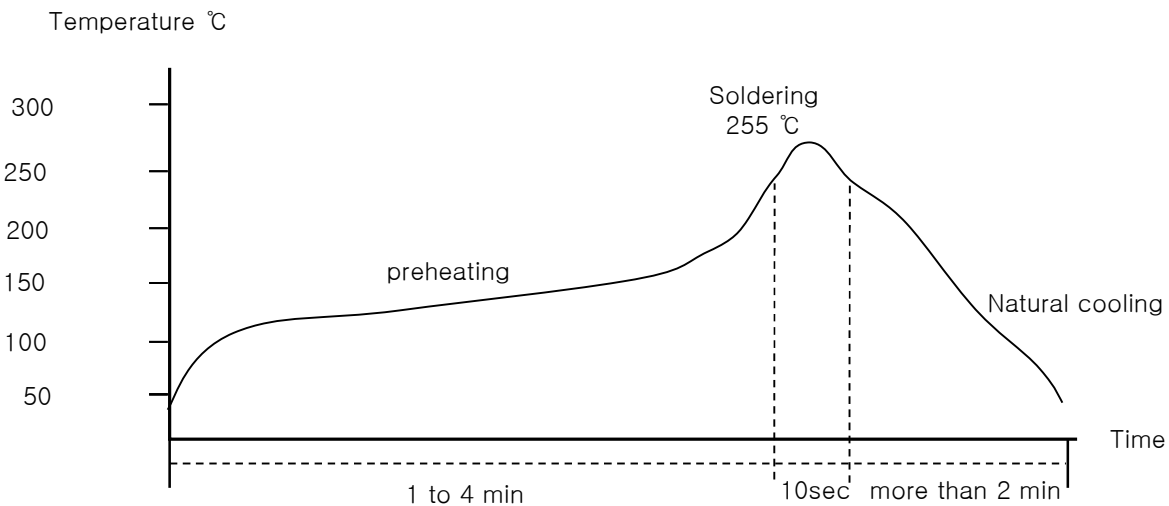

Temperature and humidity . After that , no mechanical and electrical defect should be found .

拟制	John	审核	Ruby	批准	Ruby
----	------	----	------	----	------

承认书/SPECIFICATION FOR APPROVAL

客户名称 CUSTOMER	0	客户品名 CUSTOMER P/N	MTH0650S2R2M	版别 REV.	A
产品类型 PRODUCT TYPE	贴片电感	品名 OURS P/N	MTH0650S2R2M	文件编号 FILE NO.	

八. 曲线图/CURVE

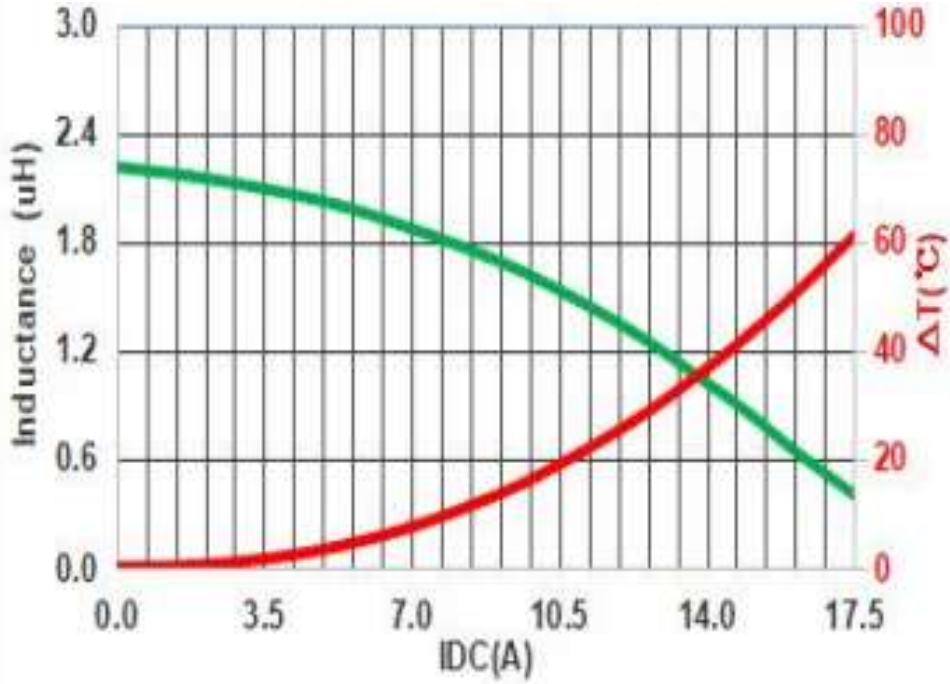

拟制	John	审核	Ruby	批准	Ruby
----	------	----	------	----	------